

# GENIE® DIGITAL WIRELESS KEYPAD

WITH INTELICODE®

This Wireless Keypad is compatible with all INTELICODE® radio equipped GENIE® products.



## FEATURES :

- Ability to Control up to three Genie® INTELICODE® Openers
- Simple to Program and Install
- PIN Codes can be up to 8 Characters
- Low Battery Power Indicator
- Stays Programmed During Battery Change
- Temporary PIN for Special Purpose Access

## TOOLS NEEDED:

- Drill with 1/16" Drill Bit
- Phillips Screwdriver
- Pencil
- Mounting Screws INCLUDED inside Battery Compartment

Interchangeable Flip-up Cover available in 3 optional Classic Colors to match your home's exterior decor

Red LED indicates Battery Power and Status during Use and Programming

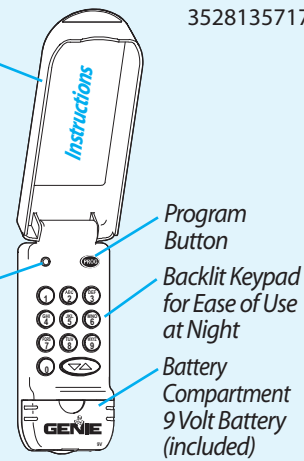

3528135717

## OPERATING INSTRUCTIONS (KEEP FOR FUTURE REFERENCE)

### ⚠ WARNING

#### A Moving Door can cause serious injury or death.

- 1 Keep people clear of opening while Door is moving.
- 2 **Do Not** allow children to play with Wireless Keypad.
- 3 During programming, the Door Opener could begin to run, so stay away from the moving Door and its parts. To keep the Door from moving, close the Door and disconnect it from the Opener by pulling the Emergency Release Cord.

#### If Safety Reverse does not work properly:

- 1 Close Door and disconnect the Opener using Emergency Release Cord.
- 2 **Do not** use Door Opener, Remote Controls, or Wireless Keypad.
- 3 Refer to Door and Door Opener Owner's Manuals before attempting any repairs.

## SECTION 1 PROGRAMMING FOR ONE DOOR OPENER

### FOR CONVENIENCE

Program Keypad **BEFORE** mounting.

#### STEP 1: SETTING YOUR WIRELESS KEYPAD PIN (PERSONAL IDENTIFICATION NUMBER)

- A** Activate programming mode.
- Press (in order) **DEF 3** **JKL 5** **PQRS 7** **PROG**.
  - Red LED blinks - once per second.
  - Enter your PIN (3 to 8 characters).
  - Press **PROG**.
  - Red LED blinks - twice per second and turns off.

#### STEP 2: PROGRAMMING ONE DOOR OPENER

- A** Find the Learn Code Button and Learn Code Indicator LED on your door opener.
- If your Door Opener has a *black Antenna Wire*, the Learn Code Button and Indicator LED are located near the Antenna. (The Light Lens may need to be opened.)
  - If your Door Opener *does not* have an Antenna, you have an External Receiver. The External Receiver cover must be removed to access the Learn Code Button and Indicator LED.



- Press the Learn Code Button.
- Learn Code Indicator LED (on Opener) will blink.
- Enter your PIN and press **▲▼** on Keypad.
- Learn Code Indicator LED stays on.
- Press **▲▼** again.
- Learn Code Indicator LED turns off.
- Press **▲▼** again.
- Door moves.

Wait until Keypad Backlight turns off (approximately 30 seconds).

#### STEP 3: OPERATING ONE DOOR OPENER

- A** To move the Garage Door.
- Enter your PIN.
  - Press **▲▼**.

### NOTE

- If the Door does not move, check the red LED on Keypad. If the LED is blinking rapidly, the PIN was entered incorrectly. After the LED stops blinking, re-enter your PIN and try again.
- Any Keypad Button will control the Door for 30 seconds after the Door starts moving.
- Rapid blinking of the red LED indicates an error. After a few seconds the LED will turn off. Start over.

Proceed to Section 3 - Mounting Instructions.

For answers to questions, call 1-800-35 GENIE, or visit [www.geniecompany.com](http://www.geniecompany.com)

Additional Genie® products can be ordered using the Accessories page in your Owner's Manual or through the 800 number above.

## SECTION 2 PROGRAMMING FOR 2 OR 3 DOOR OPENERS

### FOR CONVENIENCE

Program Keypad **BEFORE** mounting.

#### STEP 1: SETTING YOUR WIRELESS KEYPAD PIN (PERSONAL IDENTIFICATION NUMBER)

- A** Activate programming mode.
- Press (in order) **DEF 3** **JKL 5** **PQRS 7** **PROG**.
  - Red LED blinks - once per second.
  - Enter your PIN (3 to 8 characters).
  - Press **PROG**.
  - Red LED blinks - twice per second and turns off.

#### STEP 2: PROGRAMMING THE KEYPAD FOR MULTIPLE DOOR OPENERS

##### A All Door Openers will use the same PIN.

- Enter your PIN and press **PROG**.
- Red LED blinks - once per second.
- Press **PROG** again.
- Red LED blinks - twice per second.
- Press the number of Doors (total) you wish to control (**ABC 2** or **DEF 3**).
- Press **PROG**.
- Red LED blinks several times and turns off.

#### STEP 3: PROGRAMMING DOOR OPENERS

- A** Decide which Door will be Door #1, #2 and #3.
- Press the Learn Code Button (see Section 1 Step 2).
  - Learn Code Indicator LED (on Opener) blinks.
  - Enter your PIN and press **▲▼** on Keypad.
  - Learn Code Indicator LED stays on.
  - Press the number you have picked for this Door Opener (**1** or **ABC 2** or **DEF 3**).
  - Learn Code Indicator LED stays on.
  - Press **▲▼**.
  - Learn Code Indicator LED turns off.
- B** Repeat step A above for each Door Opener. Each Door Opener must be programmed to receive the signal from the Wireless Keypad.

Wait until Keypad Backlight turns off (approximately 30 seconds).

#### STEP 4: OPERATING 2 OR 3 DOOR OPENERS

- A** To move one of the Doors.
- Enter your PIN.
  - Press **▲▼**.
  - Press Door Opener number (**1** or **ABC 2** or **DEF 3**).

SEE NOTE AT BOTTOM OF SECTION 1

Proceed to Section 3 - Mounting Instructions.

## SECTION 3 MOUNTING INSTRUCTIONS

The Keypad must be mounted in sight of the Door(s), at least 5 feet above the ground and clear of any moving Door parts.

- A** Mount Keypad. (Mounting screws located inside Battery Compartment.)
- Remove Battery Cover (See Section 4 Figure 2).
  - Drill a 1/16" pilot hole for the top mounting screw.
  - Install a screw into the drilled hole, leaving a 1/8" gap between the screw head and the wall. See Figure 1.
  - Hook the Keypad over the screw.
  - Mark, drill pilot hole and fasten bottom screw.
  - Reinstall Battery Cover.

Figure 1

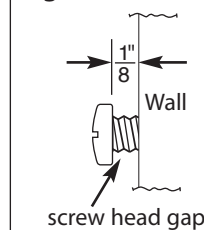

## SECTION 4 ADDITIONAL OPERATIONS

### FORGOT YOUR PIN

OR

### CHANGING YOUR PIN

- A** Erase old PIN.
- Press and hold in order - **PROG** **MNO 6** **▲▼**.
  - Red LED will blink once and turn off.
  - Release all buttons.
- B** Programming Door Opener(s).
- Return to "Programming" (Section 1 or Section 2).

### USING A TEMPORARY PIN

A temporary PIN allows temporary access to your home by repair persons, meter readers, etc. if you so desire.

- A** Enter your PIN.
- Press **PROG** **PROG** **PROG**.
- B** Enter the Temporary PIN (from 3 to 8 characters).
- Press **PROG**.

### NOTE

- DO NOT reprogram the Door Opener(s).
- Temporary PIN remains active until the next time your normal PIN is entered.

### CHANGING BATTERY

If the red LED does not blink during use, the battery needs to be changed.

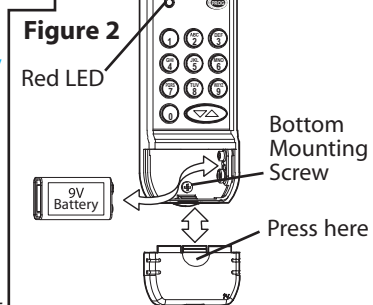

- Covers available in:
- **Brown** - P/N 35365R
  - **Almond** - P/N 35365S
  - **Sandstone** - P/N 35365T

### FCC and IC CERTIFIED

This device complies with FCC Part 15 and RSS 210 of Industry Canada. This equipment has been tested and found to comply with the limits for a Class B digital device, pursuant to Part 15 of the FCC Rules. These limits are designed to provide reasonable protection against harmful interference in a residential installation. This equipment generates, uses and can radiate radio frequency energy and, if not installed and used in accordance with the instructions, may cause harmful interference to radio communications. However, there is no guarantee that interference will not occur in a particular installation. If this equipment does cause harmful interference to radio or television reception, which can be determined by turning the equipment off and on, the user is encouraged to try to correct the interference by one or more of the following measures: 1. Re-orient or relocate the receiver antenna. 2. Increase the separation between the opener and receiver. 3. Connect the opener into an outlet on a circuit different from that to which the appliance is connected. 4. Consult the dealer. Changes or modifications not expressly approved by the manufacturer could void the user's authority to operate the equipment.

Printed in the U.S.A.